



**MASTIC EVERPLANK**

**HORIZONTAL PANEL REPLACEMENT**



## TOOLS

Be sure to have these tools available:

Watch the Mastic EverPlank repair video here:

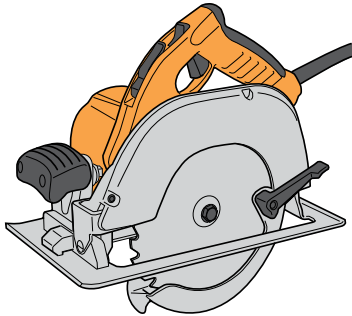

Circular Saw  
(with 120 tooth or greater plywood blade mounted in the reverse position)

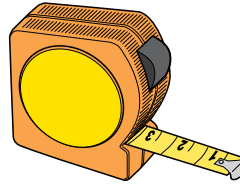

Tape Measure

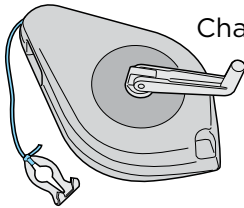

Chalk Snap Line

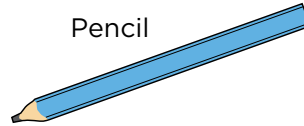

Pencil

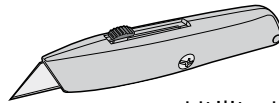

Utility Knife

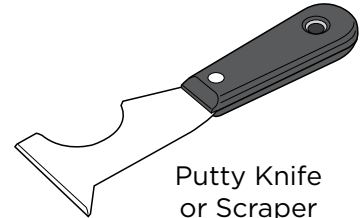

Putty Knife  
or Scraper

## SPECIAL TOOLS NEEDED

Vibra-Tite Adhesive, Applicator Gun, and Nozzle

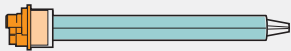

Vibra-Tite Mixing Nozzle  
(M490PB10)

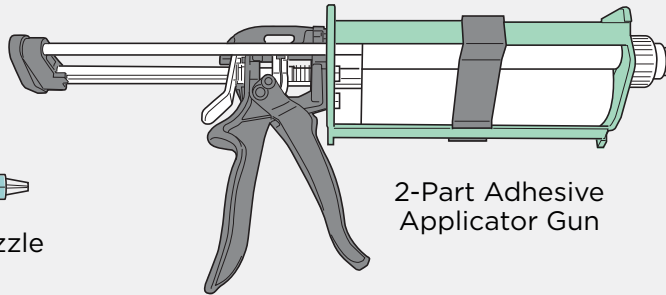

2-Part Adhesive  
Applicator Gun



Vibra-Tite  
2-part adhesive

## ADHESIVE TEMPERATURE SELECTION REQUIREMENTS:

Mastic EverPlank adhesive is formulated in two variations to help maintain a similar gel (set) time in different temperatures (warm weather and cold weather).

- **Warm weather formula (Vibra-Tite PB425)** is recommended for approximate temperatures of 65° F and greater.
- **Cold weather formula (Vibra-Tite PB320LV)** is recommended for approximate temperatures up to 65° F.

## REMOVING A DAMAGED PANEL

Measure down two inches on the damaged panel from the panel above and snap a chalk line at this level.

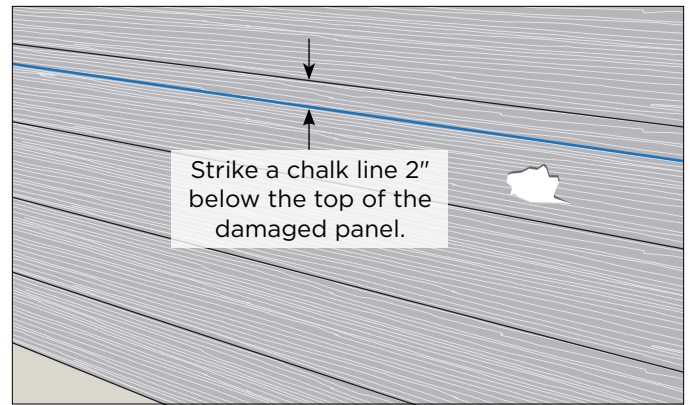

Set the depth of your circular saw blade to one-half inch. This depth will allow you to cut through the face of the damaged panel and its structural backing, without damaging the wall behind.

Cut the damaged panel at the chalk line.

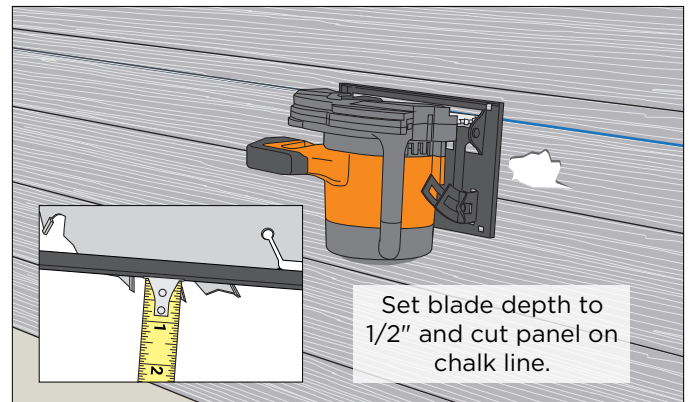

Use a utility knife to finish cutting the full width of the panel and avoid damaging the next panel.

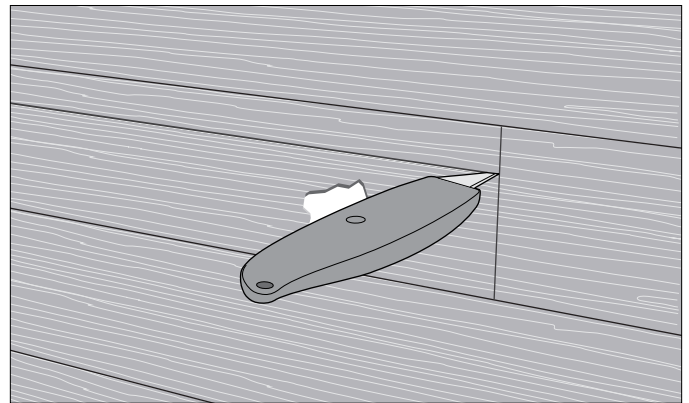

Remove the bottom portion (only) of the damaged panel, and remove any residue from the face of the damaged panel.

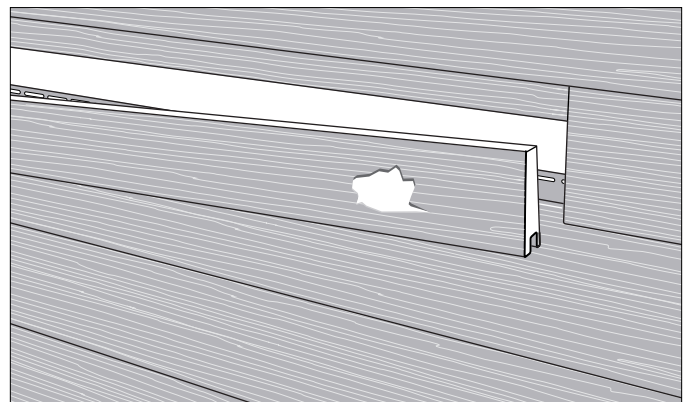



## PREPARE REPLACEMENT PANEL

Set the depth of your circular saw blade to one-quarter inch.

On your new replacement panel, mark a line one-eighth of an inch down from the top face of the panel.

Cut along the line.

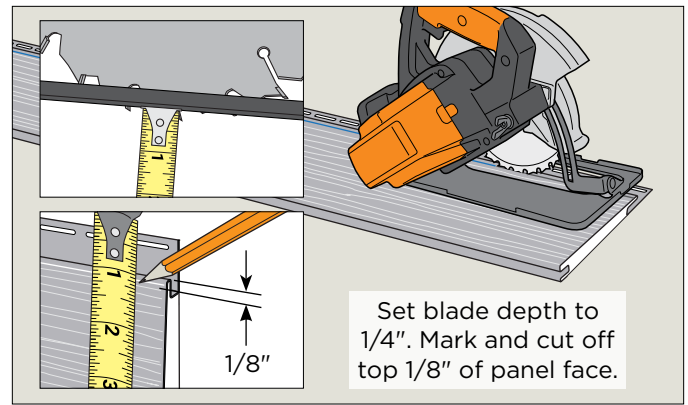

Bend and remove the top of the panel including the nail hem.

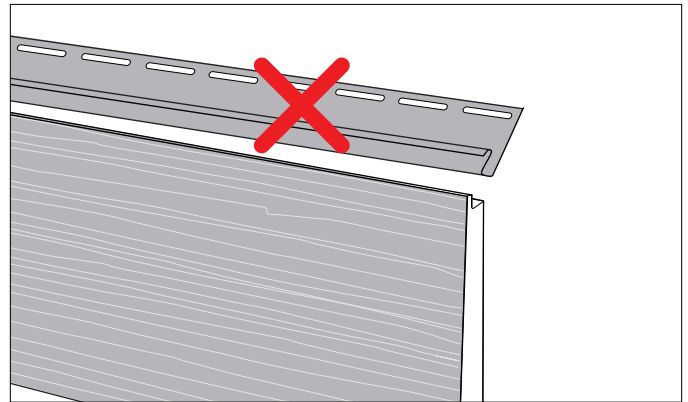

Measure and mark a line two and one-half inches from the top of the structural backing.

Use a utility knife to cut through the structural backing.

**Do NOT cut into the back of the vinyl facing of the Mastic EverPlank panel.**

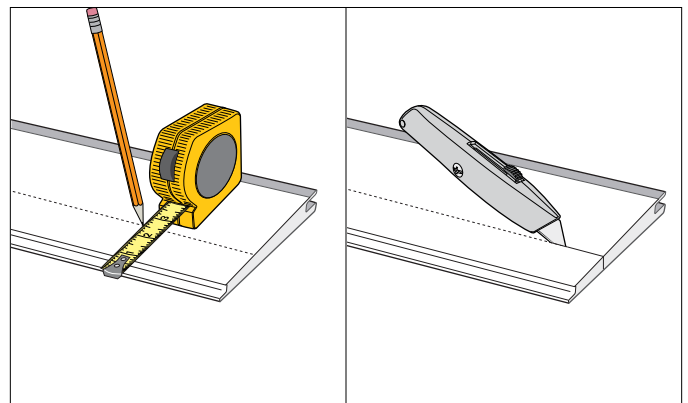

Bend the panel to release and remove the structural backing.

Scrape and remove any excess material, and remove residue from the new panel.

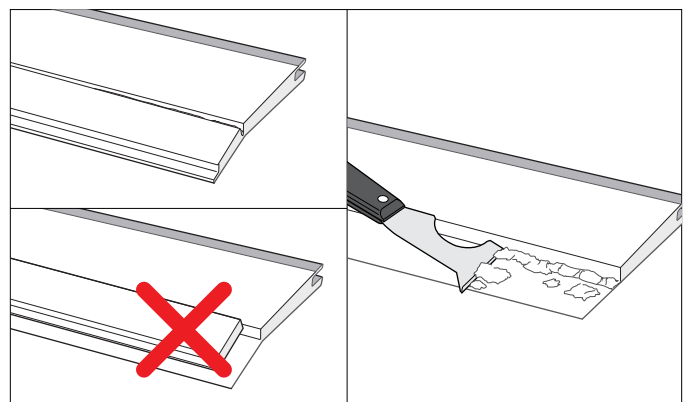

## PREPARING ADHESIVE

- Load the adhesive cartridge in the 2-part application gun. The channel will allow the nozzle to seat correctly into the gun.
  - Unscrew the cartridge retaining nut and pull the end plug. Set both aside temporarily.
  - Pump the application gun to purge a small amount of adhesive from both tubes in the combined cartridge to ensure they are flowing properly.
  - Install the mixing nozzle and hand tighten using the cartridge retaining nut.
  - Pump the application gun until the adhesive mixture flows through the outlet of the mixing nozzle. Each tube contents are color coded to ensure proper mixing. **Product is ready to use when you have a consistent blended color.**
- If the tube has been sitting unused for some time, you may need to install a new mixing nozzle.
- Retain the tube end plug to seal up the tube at the end of the day or for storage. Unmixed adhesive will not harden if the end plug is reinstalled.

## INSTALL REPLACEMENT PANEL

Apply the prepared two-part adhesive to the damaged panel with four inch beads every sixteen inches.

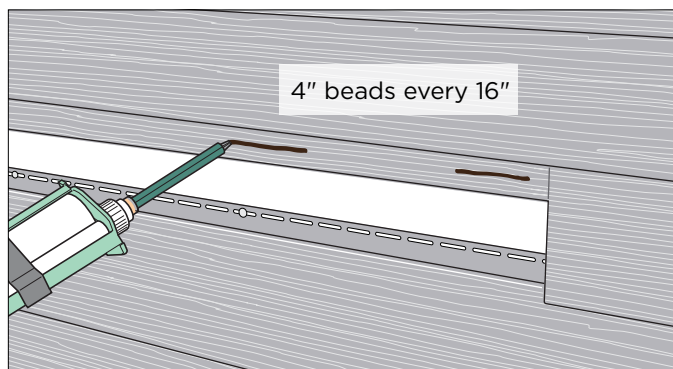

Butt the replacement panel in place and firmly lock the new panel on the panel below.

Slip the top edge of the new panel under the bottom edge of the panel above.

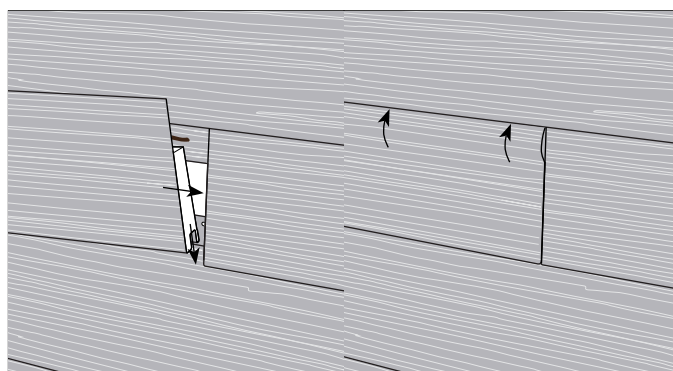

Press firmly the length of the panel, being sure the panel is seated correctly, and good adhesion is made.

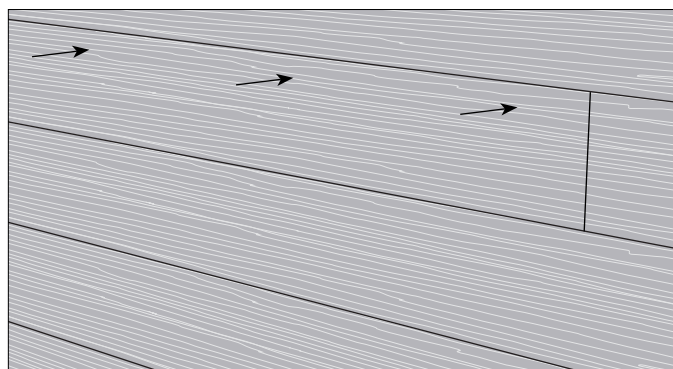



EVER BEAUTIFUL. EVER DURABLE.

MASTIC EVERPLANK

**MASTIC**  
by  **Ply Gem** | **EverPlank**™

MASTIC.COM/EverPlank | 800-962-6973  
5020 Weston Parkway, Cary, NC 27513

© 2025 Mastic Home Exteriors Inc, part of **Cornerstone Building Brands, Inc.**  
ALL RIGHTS RESERVED. 7603259991103/RevB/TH/0725



PART OF THE CORNERSTONE BUILDING BRANDS FAMILY | SIDING | WINDOWS + DOORS | SHUTTERS | METAL, TRIM + ACCESSORIES | STONE VENEER | FENCE + RAILING