



# 1500 Vinyl Collection

Sliding Windows

BUILDER



Building choice into every view.

# 1500 Sliding Windows



When you build a lot of homes, you expect a lot from your windows. Quality. Performance. Value. A company you can count on. Our new 1500 vinyl windows offer all that and more. Including a full range of options to meet your every need.

## Frame Options



Brickmould

Beveled

Flat

## Window Anatomy

Multi-chamber construction with fusion-welded sash and frame

7/8" or 1" dual or triple pane insulated glass with Warm Edge spacer saves energy

Integral J-channel for simple, secure siding installation (optional double utility trim)



## Upgrade your view

- High performance in a builder's window
- Traditional or contemporary frame design
- SDL or GBG grilles
- Sizes to meet your need
- Egress Size: 4040SL, 3050SH
- Limited Lifetime Warranty

## Color options \*Some restrictions may apply.



## Grille types Also available with no grilles.

### GBG Grilles



3/4" Flat, 5/8" or 1" Sculptured

### SDL Grilles



7/8" or 1-1/4" SDL with Shadow Bar

## Glass options Compare U-Factor ratings

### Low-E

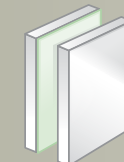

7/8" Low-E	.35	SHGC .28
One lite of Low-E.		
7/8" Low-E <sup>SC</sup>	.35	SHGC .21
One lite of solar cooling Low-E.		
7/8" Low-E2+	.30	SHGC .27
One lite of Low-E and one lite of Interior Surface Low-E.		

### Low-E with Argon

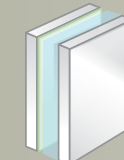

7/8" HP	.32	SHGC .28
One lite of Low-E with argon.		
7/8" HP <sup>SC</sup>	.32	SHGC .21
One lite of solar cooling Low-E with argon.		
7/8" HP2+	.28	SHGC .27
One lite of Low-E and one lite of Interior Surface Low-E with argon.		

### Triple-Glazed



7/8" HP2 <sub>Max</sub>	.26	SHGC .24
Two lites of Low-E with two chambers of argon.		
7/8" HP3 <sub>Max</sub>	.24	SHGC .21
Two lites of Low-E, two chambers of argon, one lite of Interior Surface Low-E.		
1" HP3 <sub>Max</sub>	.22	SHGC .21
Two lites of Low-E, two chambers of argon, one lite of Interior Surface Low-E.		

Values reflect 5030 call size brickmould units simulated with 3mm glass, no grilles, non-reinforced, WarmEdge spacer. Beveled frame thermal values may differ slightly.

# easyinstall

for a quick, correct fit

- Alignment clips
- Double utility trim
- Integral J-channel
- Jamb extensions or drywall receiver options
- Accessory grooves
- Protective construction film

## Window Highlights



Interior



### Removable Sash

Operating sash is removable for easy cleaning.



### Jamb Alignment Clips

Aligns and holds frame in place during installation; enables one person to center smaller windows.



### Interlocking Sash

Sash locks tightly together to help keep out intruders and inclement weather.



### Smooth Operation

Push/pull rails and wide brass rollers make opening and closing effortless.



### Forced Entry Resistant Locks

Enhanced security locks meet tough AAMA forced entry requirements. Auto-lock option available.



Auto Lock



Exterior



Optional H-LC 50 upgrade available in limited sizes





Building choice  
into every view

# WindowSpecs

## FRAME

- 3 1/2" dual wall brickmould frame depth
- 2 7/8" beveled frame depth
- 1 3/8" integral nail fin set back
- Optional 1/2" flush flange for block installs
- Optional 3 1/2" flat casing for rectangles and arches
- Optional double utility trim simplifies siding installation
- Custom and traditional sizing to meet your needs
- Integral J-pocket simplifies siding installations
- Interior/exterior accessory grooves
- Screen clip Patent #: 61738783

## SASH

- Interlocking sash with dual pile weatherstripping
- Interior glazed fixed glass
- Exterior glazed operating sash
- Dual push rails for easy operation
- Sash lifts out for easy cleaning
- Brass rollers ensure smooth operation
- Half screens (shipped separately)

## GLASS

- Double: Low-E, Low-E<sup>SC</sup>, Low-E2+, Low-E2+<sup>SC</sup>, HP, HP<sup>SC</sup>, HP2+, HP2+<sup>SC</sup>, LE<sup>PS</sup> and HP<sup>PS</sup>
- Triple: HP2<sub>MAX</sub>, HP2<sub>MAX</sub><sup>SC</sup>, HP3<sub>MAX</sub>, HP3<sub>MAX</sub><sup>SC</sup>
- Optional Warm Edge+ spacers
- Configurable STC values up to 34
- Impact, tempered, obscure and rain options
- Bronze tint, Grey tint and Black Spandrel options

## GRILLES

- GBG (Grilles Between Glass) – 3/4" Flat, 5/8" or 1" Sculptured
- SDL (Simulated Divided Lite) – 7/8" or 1 1/4" with Shadow Bar
- Colonial, Plaza, Prairie, Diamond, Gothic patterns available

## LOCKS

- Standard forced entry resistant cam lock
- Self-latching forced entry resistant auto-lock option

## PERFORMANCE CERTIFICATIONS



FLORIDA APPROVED FL16102  
For a list of Ply Gem's Florida approved products visit [floridabuilding.org](http://floridabuilding.org).



CANADIAN STANDARDS ASSOCIATION CERTIFIED



TEXAS DEPARTMENT OF INSURANCE  
WIN1767 non-impact, WIN1771 impact

Product Type	Test Unit Size (inches)	Overall Rating	NAFS Product Performance						Housing Performance			
			Air Infiltration (scfm/ft²)	Air Exfiltration (scfm/ft²)	Water Pressure (psf)	Structural Pressure (psf)	Test Standard(s)	Florida Approval	TDI Approval	AAMA 1704 Wind Zone	AAMA 1704 Egress Rated	
Horizontal Slider (XO)	63 x 48	HS-LC50	0.08	0.07	7.52	+60/-60	NAFS 05, 08, 11	FL16102	WIN-1767	WZ III	Yes	
	71.5 x 35.5	HS-LC50	0.07	0.07	7.52	+50/-50	NAFS 05, 08, 11	FL16102				
	72 x 56	HS-LC30	0.07	0.07	7.52	+30/-35	NAFS 05, 08, 11	FL16102	WIN-1767			
	72 x 72	HS-LC25	0.08	0.07	7.52	+25/-25	NAFS 05, 08, 11	FL16102	WIN-1767	WZ I	Yes	
	63 x 48	HS-LC50	0.08	0.07	7.52	+60/-60	AAMA 506-06, 08	FL16102		NA	NA	
Horizontal Slider (XOX-Even)	63 x 44	HS-LC45	0.09	0.06	6.89	+45/-45	NAFS 05, 08, 11	FL16102	WIN-1767	WZ III	No	
	72 x 56	HS-LC40	0.09	0.06	6.89	+40/-45	NAFS 05, 08, 11	FL16102	WIN-1767	WZ III	Yes	
	84 x 63	HS-LC30	0.09	0.06	6.89	+30/-30	NAFS 05, 08, 11	FL16102	WIN-1767	WZ I	Yes	
	96 x 72	HS-R15	0.09	0.06	6.89	+15/-15	NAFS 05, 08, 11	FL16102	<i>In Process</i>	WZ I	Yes	
	108 x 72	HS-R15	0.11	0.06	5.43	+15/-15	NAFS 05, 08, 11	FL16102	<i>In Process</i>	WZ I	Yes	
Horizontal Slider (XOX-QHQ)	63 x 44	HS-LC50	0.10	0.07	7.52	+50/-50	NAFS 05, 08, 11	FL16102	WIN-1767	WZ III	No	
	72 x 56	HS-LC45	0.10	0.07	7.52	+45/-45	NAFS 05, 08, 11	FL16102	WIN-1767	WZ III	No	
	84 x 63	HS-LC30	0.10	0.07	7.52	+30/-35	NAFS 05, 08, 11	FL16102	WIN-1767	WZ I	No	
	96 x 72	HS-LC25	0.10	0.07	7.52	+25/-25	NAFS 05, 08, 11	FL16102	WIN-1767	WZ I	Yes	
	108 x 72	HS-R15	0.12	0.12	5.43	+15/-15	NAFS 05, 08, 11	FL16102	<i>In Process</i>	WZ I	Yes	

Impact Rated

### Test Standards

- AAMA/WDMA/CSA 101/1.S.2/A440-05 (NAFS-05)
- AAMA/WDMA/CSA 101/1.S.2/A440-08 (NAFS-08)
- AAMA/WDMA/CSA 101/1.S.2/A440-11 (NAFS-11)

- AAMA 506-06
- AAMA 506-08

### Performance Class Designations

- R - Residential
- LC - Light Commercial

