

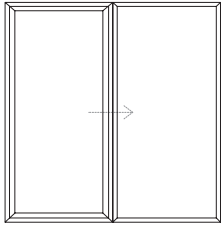

HS

3376 includes thermal break and 2 panes of glass  
 Mark IV does not have a thermal break and only one pane of glass



|        |              | Width |        |        |        |        |        |        |        |        |  |
|--------|--------------|-------|--------|--------|--------|--------|--------|--------|--------|--------|--|
| Height | RO (Inches)  |       | 12 3/8 | 18 3/8 | 24 3/8 | 30 3/8 | 36 3/8 | 46 3/8 | 52 3/8 | 62 3/8 |  |
|        | RO (mm)      |       | 365    | 467    | 619    | 772    | 924    | 1178   | 1331   | 1585   |  |
|        | OSM (Inches) |       | 14     | 18     | 24     | 30     | 36     | 46     | 52     | 62     |  |
|        | OSM (mm)     |       | 355    | 457    | 609    | 762    | 914    | 1166   | 1321   | 1575   |  |
| 12 3/8 | 314          | 12    | 305    | •      |        |        |        |        |        |        |  |
| 14 3/8 | 365          | 14    | 356    | •      |        |        |        |        |        |        |  |
| 18 3/8 | 467          | 18    | 457    |        | •      | •      |        |        |        |        |  |
| 24 3/8 | 619          | 24    | 610    |        |        |        | •      |        |        |        |  |
| 30 3/8 | 772          | 30    | 762    |        |        |        | •      | •      | •      | •      |  |
| 36 3/8 | 924          | 36    | 914    |        |        |        | •      | •      | •      | •      |  |
| 40 3/8 | 1026         | 40    | 1016   |        |        |        | •      |        |        |        |  |
| 42 3/8 | 1076         | 42    | 1067   |        |        |        |        | •      | •      | •      |  |



### 3376 Horizontal Slider

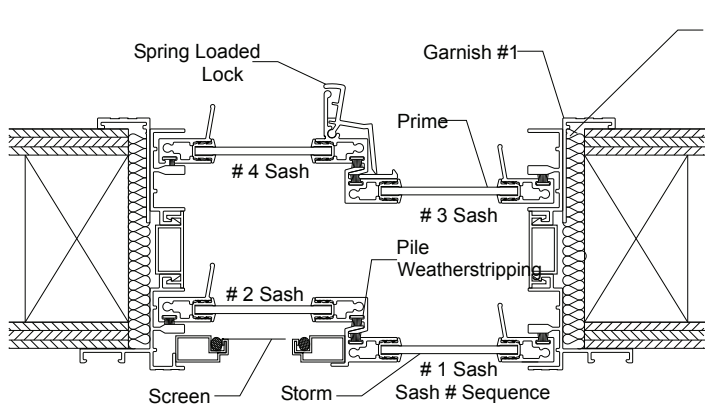

3376 Vertical Section

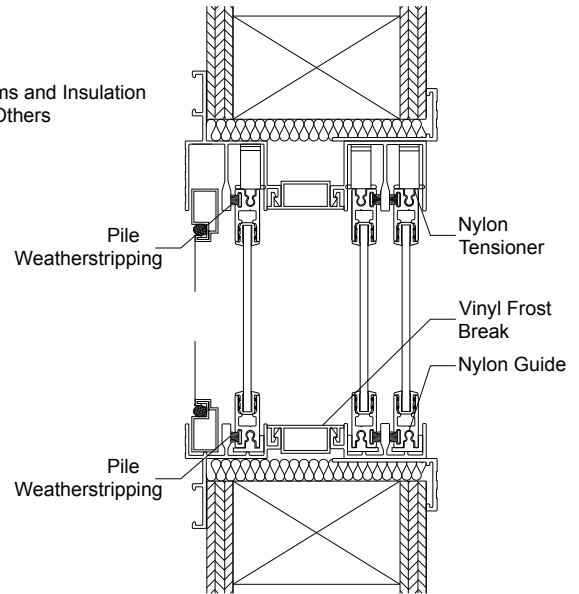

3376 Horizontal Section

### Mark IV Horizontal Slider

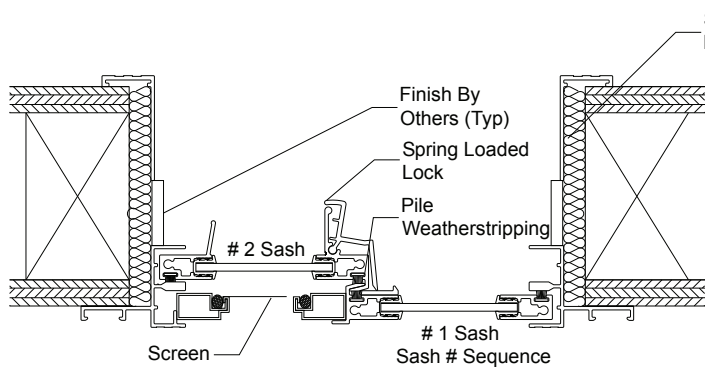

Mark IV Vertical Section

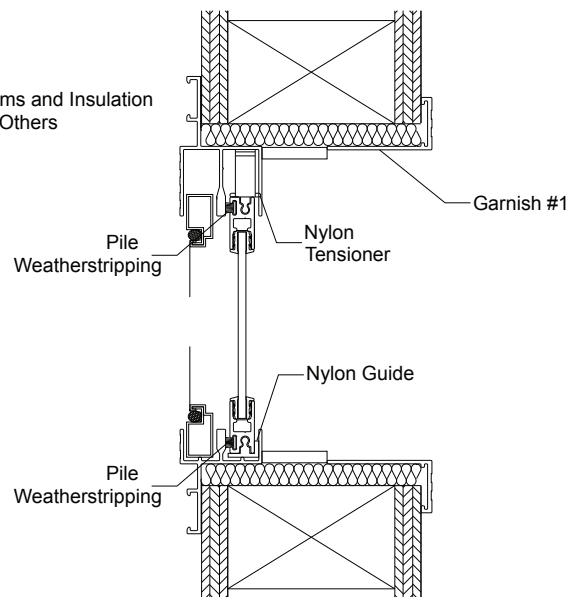

Mark IV Horizontal Section