



960 Sliding Patio Door

Recommended Reversing and Adjustment

RECOMMENDED TOOLS & ACCESSORIES

(Not supplied by Ply Gem)

- #2, #3 Phillips head screwdrivers
- Square drive screwdriver
- Flex blade putty knife
- Caulk gun
- (1) Tube clear 100% silicone caulk
- (1) Tube colored silicone caulk
- Rubber mallet

NOTE: A new aluminum threshold needs to be ordered from Ply Gem Windows in opposite handing.



READ ALL INSTRUCTIONS BEFORE BEGINNING INSTALLATION.

Ply Gem Windows recommends that trained technicians perform this procedure. Failure to follow all instructions, including adjustments to proper operating condition, may void warranty.

*Approximate time needed for reversal:
1 hour*



Remove the operating panel

1. Move the operating panel to the fixed side of door.
2. Remove the vinyl hole plugs in the operating panel lower and upper rail by gently prying them out using the flex blade putty knife.
3. Using a #3 Phillips head screwdriver, turn the adjustment screws fully counter-clockwise, dropping the panel to the fully lowered position. Screws are located within the adjustment holes on the face of the operating panel bottom rail (**Figure A**).
4. Lift the operable panel into the head pocket and swing the bottom rail over the doorsill to remove.
5. Place the panel on saw horses or equivalent.
6. Using a #2 Phillips head screwdriver, remove the screws securing the aluminum threshold to the sill.

NOTE: A new aluminum threshold needs to be ordered from Ply Gem Windows in opposite handing.



Figure A

Reverse the wheels and lock mechanisms

1. Using a #2 Phillips head screwdriver, remove the wheel assemblies (**Figure B**).
2. Reinstall the wheels at the opposite rail in the operable panel through the pre-fabricated wheel housing holes. Be sure the adjustment screws face the adjustment screw holes drilled in the rail.
3. Using a #2 Phillips head screwdriver, remove the (2) screws from the interior mounting plate and remove the interior handle and mortise snib (**Figure C**).
4. Using a #2 Phillips head screwdriver, remove the (2) screws from the mounting plate that fasten the exterior handle to the operable panel. Remove the mounting plate and exterior handle (**Figure D**).
5. Using a #2 Phillips head screwdriver, remove the lock mechanism attachment screws. Remove the lock mechanism and flip it around the opposite direction and re-insert into the operable panel. Ensure that mortise snib is in the flipped up position when lock is in open condition.
6. Reinstall the lock mechanism, mounting plate, exterior handle, mortise snib, and interior handle in the reverse order as they were removed previously.
7. Remove the lock strikes.



Figure B

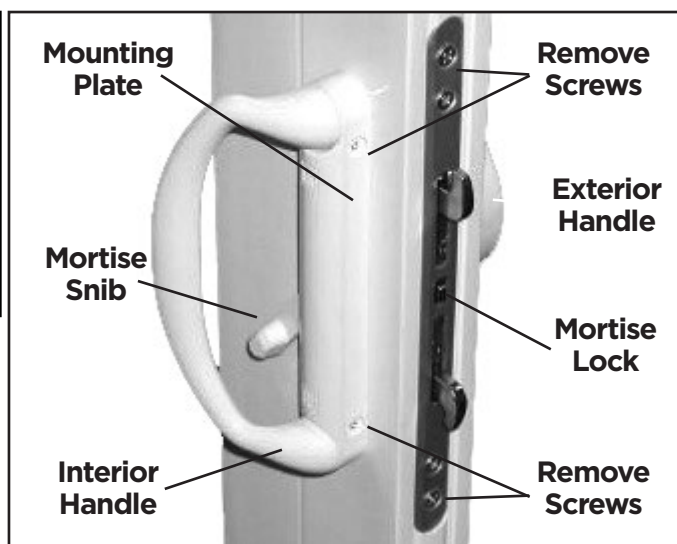

Figure C

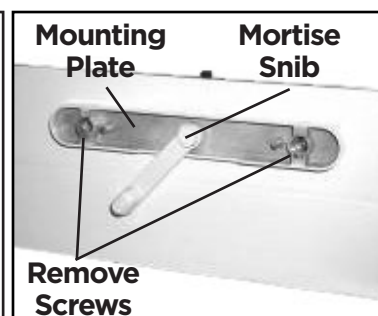

Figure D

Remove the fixed panel

⚠ CAUTION: Panels are heavy. Do not attempt to remove panels without assistance. Sharp tools may damage the door finish.

1. Using a #2 Phillips head screwdriver, remove the side panel clip assembly from door completely (**Figure E**).
2. Using a flex blade putty knife, starting at the top, pry the interlock cap from the interlock (**Figure F**).

NOTE: Glazing tape may be present securing the cap in position.



Figure E



Figure F

Remove fixed panel (Continued)

- Using a square drive screwdriver, remove (2) screws in the reversible panel brackets found in the head and sill of the fixed panel. Tilt the bracket away from the panel and lift out to remove (**Figure G**).
- From the interior, using a flex blade putty knife, carefully run the blade around the perimeter of the fixed panel where it meets the frame, cutting the silicone seal between them (**Figure H**).
- Pulling from one corner, carefully pull the fixed panel away from the main frame.
- Slide the panel sideways until it is in the center of the opening and remove the panel (**Figure I**).
- Clean any remaining silicone from the main frame and fixed panel by peeling it away with your fingers or scrape it off with the putty knife.
- Using a #2 Phillips head screwdriver, remove the anti-lift blocks from head of operating panel side vent channel in the head.



Figure G



Figure H



Figure I

Reinstall the fixed panel

⚠ CAUTION: Panels are heavy. Do not attempt to remove panels without assistance.

- Apply a bead of 100% clear silicone (approximately 3/16" diameter) to the fixed side of the main frame (**Figures J & K**).
- To reinstall the fixed panel, turn the panel so that the top rail is now the bottom rail. Place the panel into the frame approximately 6" from the fixed panel side jamb of the main frame and slide the panel sideways along the main frame until it is flush against the jamb of the main frame (**Figure L**).
- Reattach the side bracket to the main frame and fixed panel.
- Insert the reversible panel brackets into holes punched in head and sill of main frame by inserting the short leg facing toward hole first, then rotating the bracket until it lays flush against the interlock.
- Using the square drive screws, reattach the reversible panel brackets to the fixed panel.
- Using a rubber mallet, reattach the interlock cap over the interlock of the fixed panel (If glazing tape no longer sticks, beads of silicone can be used to secure the cap to the interlock).
- Using #2 Phillips head screwdriver, secure the new aluminum threshold to the door sill.
- Patch holes in the vent channel of the main frame in the fixed panel jamb using appropriately colored sealant.



Figure J

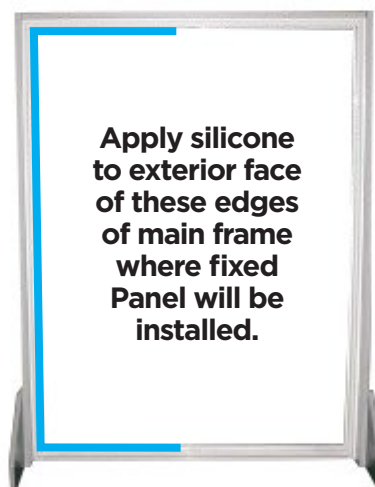

Figure K



Figure L

Reinstall operable panel

⚠ CAUTION: Panels are heavy. Do not attempt to remove panels without assistance.

1. Turn the operable panel so the wheels are in the bottom rail. Lift the top of the panel into head of the main frame and swing bottom of the panel into the sill vent channel (**Figure M**).
2. Using a #3 Phillips head screwdriver, raise the wheels by turning the adjustment screws clockwise until the vent does not ride on the panel track and the panel is squarely within the main frame.
3. Locate where the lock strike needs to be mounted in the jamb.
 - A. Lock the lock strike onto the lock hooks by depressing the lock release mechanism and moving the mortise snib so the lock is in the closed condition.
 - B. Move the operable panel so that the lock strike comes even with the main frame (**Figure N**).
 - C. With a pencil, lightly mark where the top of the lock strike would rest on the jamb of the main frame.
 - D. Move the operable panel back.
4. Place the lock strike so the top is level with the pencil mark and secure the strike to the main frame in the oblong slots in the strike itself, ensuring it is centered on the ID line in the main frame jamb (**Figure O**).
5. Close the operable panel and test the lock to see if it works properly. If it does not work properly, try adjusting the height of the strike.
6. Once the lock works properly and the strike has been properly adjusted, secure the strike through the center mounting hole of the strike using a screw long enough to penetrate the framing lumber.
7. Reinsert vinyl adjustment hole plugs in top and bottom rail of operable panel.
8. Using a #2 Phillips head screwdriver, reinstall the anti-lift blocks in the vent channel of the operable panel in the head.



Figure M



Figure N

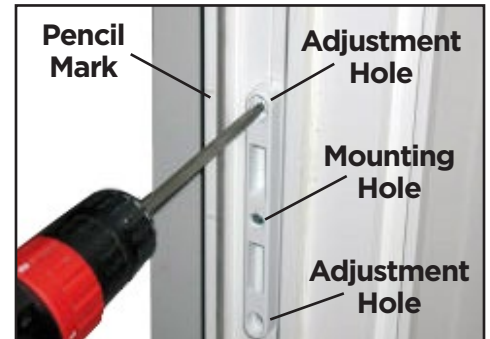

Figure O