



**Ply Gem<sup>®</sup>**



# NEW CONSTRUCTION NAIL FIN INSTALLATION



## IMPORTANT! READ ALL INSTRUCTIONS BEFORE BEGINNING INSTALLATION.

Follow your local building codes, customs and building practices for additional installation requirements. The manufacturer will accept no responsibility for air or water leakage above, under, or around the window unit. These instructions are general in nature; for detailed installation instructions by product, contact **Ply Gem Windows & Doors at 1-888-9PLYGEM.**

- (Required)** The Rough Opening should be level, plumb, and square, and should be sized according to **Figure 1**.
- (Recommended)** If a weather resistant barrier is used, follow the barrier manufacturer's recommendations for treatment of window openings.
- (Recommended)** If pan flashing is used, it should be installed at this time. Follow the pan flashing manufacturer's recommendations (or ASTM 2112 standards), making sure that the product provides an adequate sill dam height to the interior.
- (Required)** A generous amount of Exterior Grade Caulk/Sealant designed for Doors and Windows must be applied at all joints of the nailing flange intersections, to include applying a generous (at least 3/8") continuous bead of exterior-grade sealant



Figure 1

to ensure an adequate seal between the back of the nailing fin and the exterior surface of the rough opening (reference **Figure 3**).

**▲ If using dedicated pan flashing, do not seal the lower sill nailing fin so as to provide adequate drainage.**

- (Required)** With the window closed and locked, place it in the rough opening and center it from side to side and top to bottom.
- (Required)** With a single approved fastener (see Chart A), fasten the window through the nailfin near the top center of the window.
- (Required)** Square the window side to side (shimming if necessary - see **Figure 2**) to maintain square and plumb jambs. Make sure the window sill and head are level and not crowned and the jambs are not bowed. If your window is a horizontal sliding window, make sure each meeting rail is supported. **▲ NOTE: Over-shimming can cause bowing and prevent proper window operation.**
- (Required)** After checking the operation of the window, complete the fastening by installing fasteners through the nailing fin according to **Chart A**.
- (Recommended)** Following the flashing manufacturers' recommendations, apply flashing to the nail fins and surrounding wall surface starting with the bottom, then the sides, and finally the top, creating a shingle effect (reference **Figure 4**).

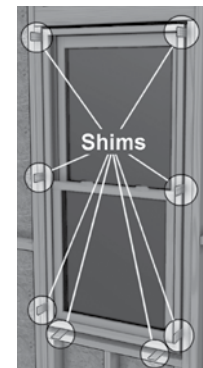

Figure 2

**▲ NOTE:** Where pan flashing is present, do not use flashing that will impede proper drainage of the pan on the bottom.

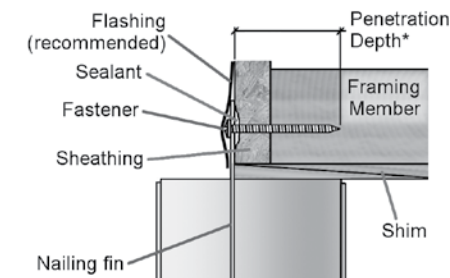

Figure 3 - General Installation

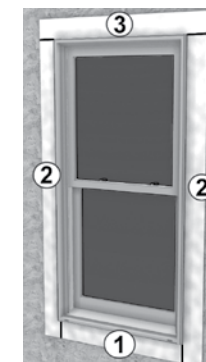

Figure 4

**▲** Consult local building codes to verify that sheathing is considered a framing member.

### PRECAUTIONARY NOTES

- Store windows and doors oriented in upright position (not laying horizontally) in a dry, well-ventilated location not to exceed 6 deep and should be of similar size.
- Keep window and door units out of direct sunlight exposure during storage and remove protective films immediately after installation.
- For trim and siding, allow 1/8"-1/4" gap all the way around the window frame to allow for expansion. If exterior is brick or masonry, leave a 3/8" gap between the bottom sill of the window and the masonry to avoid "brick binding".
- Exterior wall systems like stucco and EIFS must be designed to manage moisture around the window opening.
- Follow the siding manufacturer's requirements for sealing between the siding and window frames.
- Any low-expansion foam used should conform to AAMA 812-04 (see manufacturer's requirements), but any binding or damage of any type caused by the insulation will not be covered under warranty.
- Do not block or seal weep holes.
- Do not fasten through the sill track.

### Chart A - Fastener Schedule for New Construction Aluminum

<b>Nailfin Fastener Perimeter Spacing</b>	12"
<b>Fastener Distance from Window Corners</b>	6"
<b>Bldg Fastener to Wood Framing Member Penetration</b>	1 1/2" min.
<b>Min. Corrosion-Resistant Nail Size</b>	3/8" Minimum Head diameter
<b>Steel Construction</b>	Fastener Length must be Long Enough to Penetrate the Structural Framing Member at Least 3 Full Threads
<b>Min. Corrosion-Resistant Screw Size</b>	#8 or Larger Pan or Truss Head

**Note:** Muller units may have additional instructions attached to the unit.

PLACE  
NFRC  
STICKER  
HERE

